



## Home

A **house** is a home.

An **apartment** is a home.



## Bedroom

A **bed** is in the bedroom.

A **dresser** is in the bedroom.

A **closet** is in the bedroom.



## Bathroom

A **toilet** is in the bathroom.

A **sink** is in the bathroom.

A **shower** is in the bathroom.

A **bathtub** is in the bathroom.

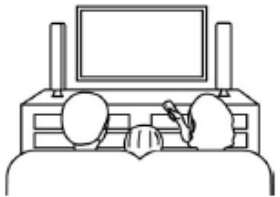

## Living Room

A **sofa** is in the living room.

A **TV** is in the living room.

A **bookcase** is in the living room.



## Dining Room

A **table** is in the dining room.

A **chair** is in the dining room.

A **rug** is in the dining room.

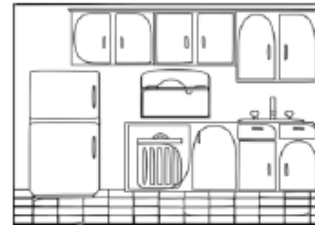

## Kitchen

A **cabinet** is in the kitchen.

A **stove** is in the kitchen.

A **fridge** is in the kitchen.



\_\_\_\_\_



\_\_\_\_\_



\_\_\_\_\_



\_\_\_\_\_



\_\_\_\_\_



\_\_\_\_\_



\_\_\_\_\_



\_\_\_\_\_



\_\_\_\_\_



\_\_\_\_\_



-----



-----

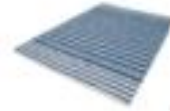

-----



-----



-----

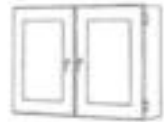

-----



-----



-----

1.

What is this?

- Ⓐ a bathroom
- Ⓑ a bookcase
- Ⓒ a toilet
- Ⓓ a cabinet

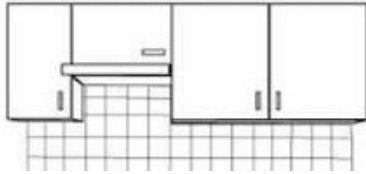

2.

Where can you find this?

- Ⓐ in the kitchen
- Ⓑ in the bedroom
- Ⓒ in the bathroom
- Ⓓ a sofa



3.

Which of these is a home?

- Ⓐ a closet
- Ⓑ an apartment
- Ⓒ a garage
- Ⓓ a chair

4.

Which can you find in a living room?

- Ⓐ a sofa
- Ⓑ a bed
- Ⓒ a sink
- Ⓓ a refrigerator

5.

Where can you put this?

- Ⓐ in a sink
- Ⓑ in a bookcase
- Ⓒ in a dresser
- Ⓓ in a refrigerator



6.

What can you find here?

- Ⓐ a chair
- Ⓑ a sink
- Ⓒ a television
- Ⓓ a sofa

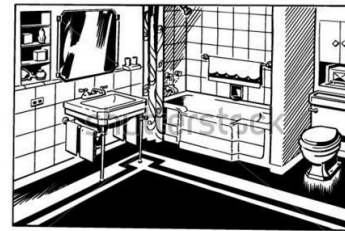

7.



**Where can you put these?**

- Ⓐ a cabinet
- Ⓑ a bed
- Ⓒ a rug
- Ⓓ a shower

8.

**Where can you do this?**

- Ⓐ a bedroom
- Ⓑ a sofa
- Ⓒ a sink
- Ⓓ a dining room



9.



**Where can you do this?**

- Ⓐ a bathroom
- Ⓑ a shower
- Ⓒ a bedroom
- Ⓓ a dining room

10.



**Where can you do this?**

- Ⓐ a bathtub
- Ⓑ a stove
- Ⓒ a bookcase
- Ⓓ a closet